

**609L UltimateTaste 900 french door refrigerator, natural stainless with FlexFresh fully convertible entertainer's drawer, TasteLockAuto Easy-glide crispers with automatic humidity control and in door ice & water dispenser**



## Product Details

### FEATURES

---

FlexFresh™ Fully Convertible Entertainer's Drawer

SmartSplit Door Design

Connectivity

Mark resistant real stainless steel

---

Filtered ice and water

Slide-back and Flip-up shelving

SnackZone

UltraChill

---

Drinks Storage

Snacks Storage

FlexStor

FreshPlus Cooling  
Keep your food at its best with our innovative FreshPlus technology. Whenever the fridge door is open, it immediately begins recooling to replace the lost cold air.

---

Quick freeze function great for when a large quantity of food is added to the freezer

Boost mode  
After a large grocery shop, use the Boost function when adding food to your fridge, so that the temperature decreases for 90 minutes before returning to the pre-set mode.

TwinTech Cooling System

Electronic controls with LED display and acoustic signal  
Electronic controls with LED display and acoustic signal

---

Holiday mode  
Going away? Set the fridge to Holiday Mode to help minimise defrosting and save energy.

R600a refrigerant better for the environment

LED lighting

Frost free  
Save your precious time with a freezer that doesn't ice up and need manual defrosting.

---

Fresh Sense deodoriser  
Keep your fridge and its contents smelling fresh with the in-built Fresh Sense deodoriser.

---

## BENEFITS

---

**Understanding new capacity and energy ratings**  
From the 15th August 2021, the way refrigerators are tested to calculate Energy Star Ratings and energy consumption have changed. This means that the capacity and energy rating calculations have changed, however the product remains unchanged. Be sure to check all new ratings to ensure that your comparisons are consistent with the new standards.

**A place for everything**  
We've thought long and hard about what you need in a fridge. Which is why you'll find a host of ingenious zones to help you organise your drinks and other items and even adjust micro-temperatures for perfect cooling. The FlexFresh fully convertible entertainer's drawer lets you dial up or down the cold air from -23C to +7C so your creation is revealed at its best. Likewise, you can store your drinks in the special drawer and set the temperature for perfectly chilled champagne or ice-cold drinks. Store your go-to essentials in a special SnackZone for the ultimate in organisation.

---

**Intuitive door design**  
With optimally split doors you have more usable space in your refrigerator door and can effortlessly reach for larger items, saving you the need to open both doors every time.

**Fresh is best**  
Our innovative TasteLock crispers automatically control the humidity levels to keep your fruit and vegetables at their best for longer. While Easy-glide crisper drawers open effortlessly, even when they're full.

---

**Stylish and smart**  
High quality, mark-resistant real stainless steel, now available in a new chic dark hue or classic natural stainless steel, lends a touch of class to any kitchen. Inside, the generous interior marries innovation and style in equal measure.

**Connectivity**  
Fresh ingredients form the most important part of every meal. With the new Electrolux Life app, you can confidently know that your produce is in the desired conditions by being able to monitor & adjust its temperature from the palm of your hand. Set your Entertainers Drawer to the right temperature when you're out gathering fresh produce, and receive alerts through the app when the desired temperature is reached. Ensure you always have fresh filtered water, as you get a reminder when its time to change the filter cartridge, or an alert when the door is accidentally left open. Let the refrigerator do the thinking so you can effortlessly plan your next get together.

---

#### Connectivity Terms and Conditions

Minimum requirements: Minimum requirements : Apple iOS 11.1 / Android 7.0 and above. You will need to install the Electrolux Life app, create an Electrolux account and accept the Terms and Conditions and Electrolux's Privacy Policy in the app to use the connected features of the appliance. Internet and Wi-Fi connections are required to use the full features of the app and the appliance. Minimum requirements, apps and services are subject to change without notice.

---

#### Thirst-quencher

Like a cool glass of pure, filtered water? Your fridge is there to deliver, any time of the day or night at the touch of a button.

---

#### Ice on the go

You'll love the efficient, always-ready ice-maker in your new fridge. Efficient and compact, it's ideal for hot summer days or effortless entertaining.

---

#### Smart on space

The thoughtful Slide-back and Flip-up shelving means you can store that two-tiered birthday cake for the big moment, no problem.

---

#### SnackZone

The SnackZone is the ideal compartment for keeping those smaller ingredients separate for easy access such as fruit for your morning smoothie allowing you to be prepared before the week begins.

---

#### Designed just for you

Customise your fridge just the way you want it. FlexStor™ makes it simple to arrange the fridge to your needs with adjustable door bins and shelves. Different sized compartments effortlessly accommodate items big or small.

---

#### Keep it cool

The fridge door is one of the most opened in any household, which is why we came up with FreshPlus technology to help maintain the perfect temperature inside your fridge. It automatically detects when it needs to begin cooling, keeping the temperature down to lock the freshness in.

---

#### Increase the chill

With a combination of Quick Freeze and Boost mode, you will always be prepared when entertaining. After a large shop, Boost Mode increases the chill rate of the refrigerator for 6 hours whilst the Fast Ice function lowers the freezer to -23C for 12 hours, before returning to their pre-set temperatures, to ensure your produce stays fresher longer.

---

#### UltraChill

The UltraChill setting is a deep chill at -2C which keeps meat and fish fresh in optimum condition for longer without freezing. This ensures the fresh texture is maximised and moisture loss is reduced compared to regular deep freezing. This saves your time defrosting meat and more time to enjoy with your guests.

---

#### Snacks Storage

Store your specialty meats and cheese at 3C, the ideal temperature for storing your antipasto platter, ready to be enjoyed when your guests arrive.

---

#### Drinks Storage

Store your drinks at the ideal temperature every time by setting the drawer at 7C for perfectly chilled wine and champagne, or at 0C for icy cold drinks.

---

#### Effortless access

It is one of the most hardworking appliances in your house, so it makes sense your fridge takes the effort out of simple tasks. Our smooth telescopic runners ensure you can reach the very back of the crisper and freezer drawers easily.

---

#### TwinTech Cooling System

Two independent cooling systems work together to deliver lasting freshness. One cooling system chills the freezer so no frost builds up. The other cools the refrigerator, providing stable temperature and humidity.

---

## Specifications

### PRODUCT PROFILE

Domestic warranty details (yrs)	2
Additional domestic warranty for the sealed refrigeration system only (yrs)	3
Refrigerator Type	french door
Exterior door finish	Stainless steel
Handle design	integrated
Fridge door opening	left and right
Cooling system	frost free
Freezer door opening	drawer
Refrigerant	R600a
Dispenser type	ice and water
Plumbed water supply required	Yes

### DIMENSIONS

Total height (mm)	1782
Cabinet height (mm)	1756
Total width (mm)	913
Cabinet width (mm)	908
Total depth (mm)	746
Cabinet depth (mm)	625
Depth door open 90degree (mm)	1189
Air space above cabinet (mm)	25
Food Compartment Capacity (L) - AS/NZS 4474.1 2007 (IEC 62552- 2015) *	371
Freezer Compartment Capacity (L) - AS/NZS 4474.1 2007 (IEC 62552- 2015) *	165
Convertible Compartment Capacity (L) - AS/NZS 4474.1 2007 (IEC 62552- 2015) *	73
Total Capacity (L) - AS/NZS 4474.1 2007 (IEC 62552- 2015) *	609

## DIMENSIONS

---

Food compartment capacity (gross in litres)	413
--	-----

---

Freezer compartment capacity (gross in litres)	188
---	-----

---

Convertible Compartment/Drawer capacity (gross in litres)	80
---	----

---

Total Gross Capacity (L)	681
--------------------------	-----

---

Food compartment capacity (net in litres)	363
--	-----

---

Total Net Capacity (L)	541
------------------------	-----

---

## ENERGY

---

Energy Star Rating - AS/NZS 4474.1 2007 (IEC 62552- 2015) *	3.5
---	-----

---

Energy Consumption (kWh/year) - AS/NZS 4474.1 2007 (IEC 62552- 2015) *	501
---	-----

---

Energy Star Rating AS/NZS 4474.2:2009	3
--	---

---

Energy consumption AS/NZS 4474.2:2009 (kWh/yr)	560
--	-----

---

## REFRIGERATOR SYSTEM

---

Controls	electronic (with display)
----------	---------------------------

---

Controls location	internal
-------------------	----------

---

Controls type	touch
---------------	-------

---

Control functions	quick freeze function,quick chill,lock,ice maker,wi-fi connected
-------------------	--

---

Door alarm	fridge and freezer
------------	--------------------

---

**FOOD COMPARTMENT**

---

**SHELVING**

---

Shelf material	glass
Type of shelf	spill safe shelf,adjustable shelf
Flip up shelf	1
1/3 width shelves	1
2/3 width shelves	1

**LIGHTING**

---

Feature lighting	LED
Main light	LED

**FOOD COMPARTMENT DOOR**

---

**BINS**

---

Deep bottle bin	1
Shallow bin	2
1/3 width bins	1

**CRISPERS**

---

Crisper lid/shelf	plastic
Crispers Runner system	telescopic
Crisper features	automatic humidity control,fully sealed
1/3 width crisper	1
2/3 width crisper	1

**OTHER PROPERTIES**

---

Other Properties-FOOD COMPARTMENT	Egg tray,Snack zone
-----------------------------------	---------------------

**DAIRY COMPARTMENT**

---

Half width, with lid	1
----------------------	---



Expandable bin 1

---

## SPECIAL COMPARTMENTS

---

Small items bin 1

---

## FREEZER COMPARTMENT

---

### ICE FACILITY

---

Ice Maker Automatic

---

## LIGHTING

---

Main light LED

---

## EXTERNAL

---

Dispenser through door ice and water

---

## BASKET/DRAWER

---

Full width plastic basket 1

---

Basket/Drawer runner system telescopic

---

Drawer divider 2

---

Full width deep plastic basket 1

---

## Dimensions

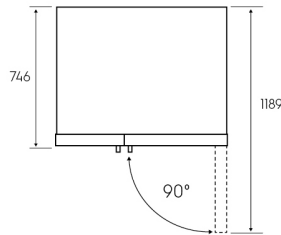
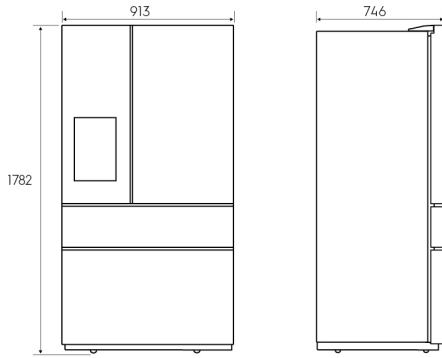

### Minimum Recommended Airspaces

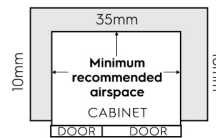
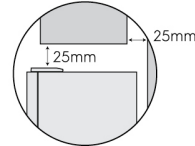

**Please note:** Doors are designed to sit proud of cabinetry (not flush)

Front face of bench aligned to front corner edge of cabinet.

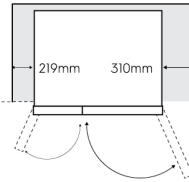

When positioned in a corner area, spacing of at least 310mm on the right hinge side and 219mm on the left hinge side will allow the doors to open enough to enable the removal of bins and shelves.

Dimensions	Product Height	Product Width	Product Depth	Product Depth (Door Open)	Airspace	Side - both	Top	Behind
EHE6899BA	1782	913	746	1189	EHE6899BA	10	25	35
EHE6899SA	1782	913	746	1189	EHE6899SA	10	25	35

For connection kit installation instructions go to [electrolux.com.au](http://electrolux.com.au)

**Important!** Please ensure that the access to your kitchen (including doorways, corridors, island benches, etc) allows sufficient clearance to move your fridge into position.

**Please note!** Dimensions to be used as a guide only. All customers MUST refer to the user manual supplied with the product for detailed installation instructions.

© 2021 Electrolux Home Products Pty Ltd. E\_DIM\_EHE6899BA-SA\_Sep21

## Terms and Conditions

### IMPORTANT

This is a guide of product dimensions only. For complete installation instructions, refer to the manual provided with product.

### PRODUCT INFORMATION

The descriptors and illustrations in this publication apply to the specific products and models described as at the date of issue. Under our policy of continuous product development, product specifications may change without notice. Prospective purchasers should therefore check with their retailer to ensure this publication correctly describes the products that are being offered for sale. All information supplied is to be used for general reference purposes only and is on the understanding that Electrolux Home Products Pty Ltd (Australia) and Electrolux (NZ) Ltd (New Zealand) will not be liable for any loss, liability or damage of whatever kind arising as a result of reliance on such information. Colours of products illustrated are as close as printing limitations allow. Electrolux will at all times comply with its obligations pursuant to law including Trade Practices (Australian Consumer Law) Act and Regulations.

### WARRANTY

This warranty only applies to Appliances purchased and used in Australia or New Zealand and used in normal domestic applications and is in addition to (and does not exclude, restrict, or modify in any way) any non-excludable statutory warranties in Australia or New Zealand. All warranties are subject to the conditions set out in the warranty card accompanying the product when purchased.

#### ELECTROLUX HOME PRODUCTS AUSTRALIA

telephone: 1300 363 640

fax: 1800 350 067

email: [customercare@electrolux.com.au](mailto:customercare@electrolux.com.au)

web: [www.electrolux.com.au](http://www.electrolux.com.au)

#### ELECTROLUX HOME PRODUCTS NEW ZEALAND

telephone: 09 573 2230

fax: 09 573 2221

email: [customercare@electrolux.co.nz](mailto:customercare@electrolux.co.nz)

web: [www.electrolux.co.nz](http://www.electrolux.co.nz)