

Ecco Shower Mixer
Trim Kits Only

Nero

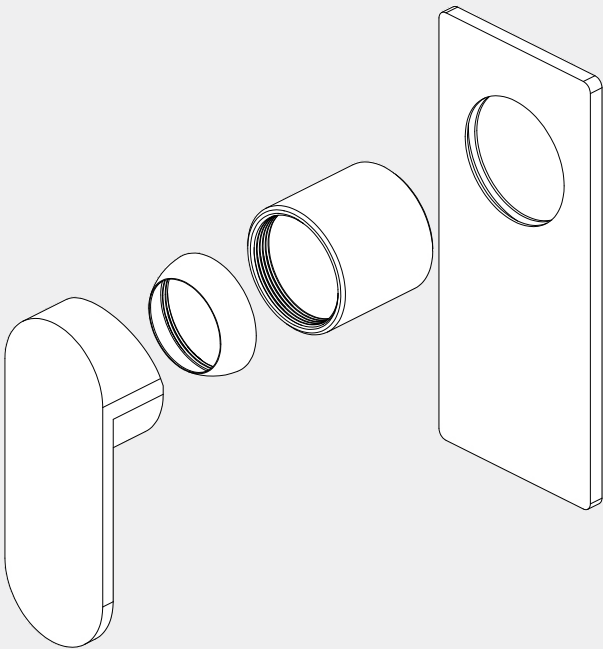

Versions:202401

Drawing	Specifications	Packaging Includes						
<p>Technical drawing of the Ecco Shower Mixer Trim Kit. The front view shows a rectangular plate with a rounded rectangular cutout. Dimensions: overall width 65, overall height 150, cutout height 112. The side view shows the handle and cartridge assembly. Dimensions: handle width 8.5, cartridge width 56.8.</p>	<p>Watermark License WM-060073</p> <p>Temperature Rating Min 1°C-Max 75°C</p> <p>Pressure Rating Min 150kpa - Max 500kpa</p> <p>Finish & SKU</p> <table><tr><td> Chrome NR301311tCH</td><td> Gun Metal NR301311tGM</td><td> Brushed Nickel NR301311tBN</td></tr><tr><td> Matte Black NR301311tMB</td><td> Brushed Gold NR301311tBG</td><td></td></tr></table>	Chrome NR301311tCH	Gun Metal NR301311tGM	Brushed Nickel NR301311tBN	Matte Black NR301311tMB	Brushed Gold NR301311tBG		<p>Packaging Includes</p> <ul style="list-style-type: none">1x Plate1x Handle1x Cartridge Bell1x Dressing Ring
Chrome NR301311tCH	Gun Metal NR301311tGM	Brushed Nickel NR301311tBN						
Matte Black NR301311tMB	Brushed Gold NR301311tBG							

*Dimensions are nominal measurements only.

Installation Instruction For Trim Kits Only

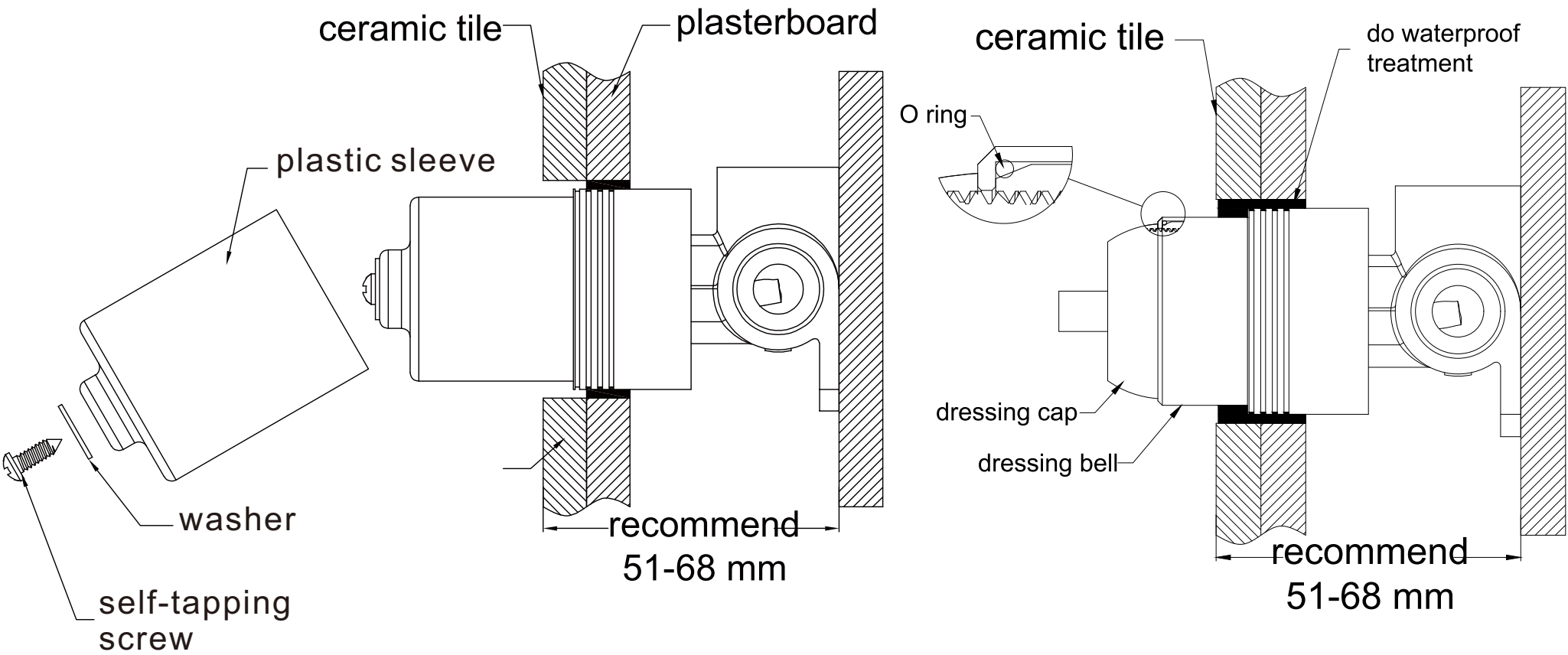

1. Drill a $\phi 50\text{mm}$ hole in the ceramic tile, then position it as shown in the above diagram.
2. Undo the self-tapping screw, washer, plastic sleeve.
3. Insert the O ring to the dressing bell groove, and slide the dressing bell onto cartridge.
4. Apply waterproof treatment to the area in the diagram above.
5. Tighten the dressing ring on the dressing bell.

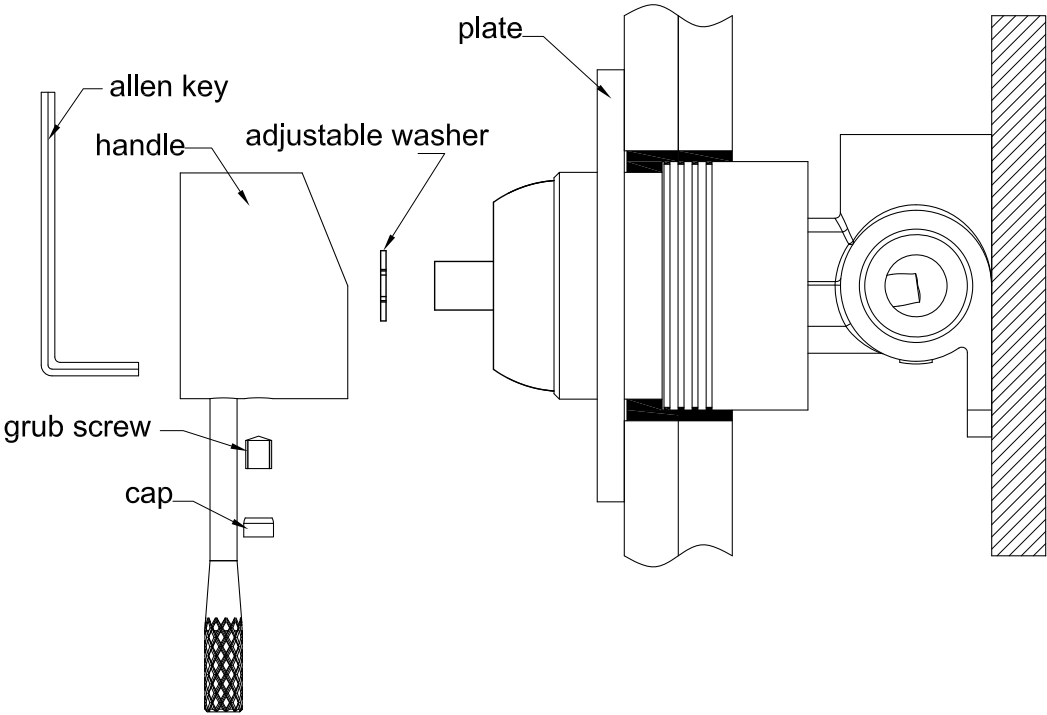

6. Slide the backplate onto the wall.
7. Attach the washer to the cartridge rod, position the handle, tighten it with a grub screw using an Allen key, and cap the grub screw hole.

Nero

