

### Nurse Call Button Wiring Installation

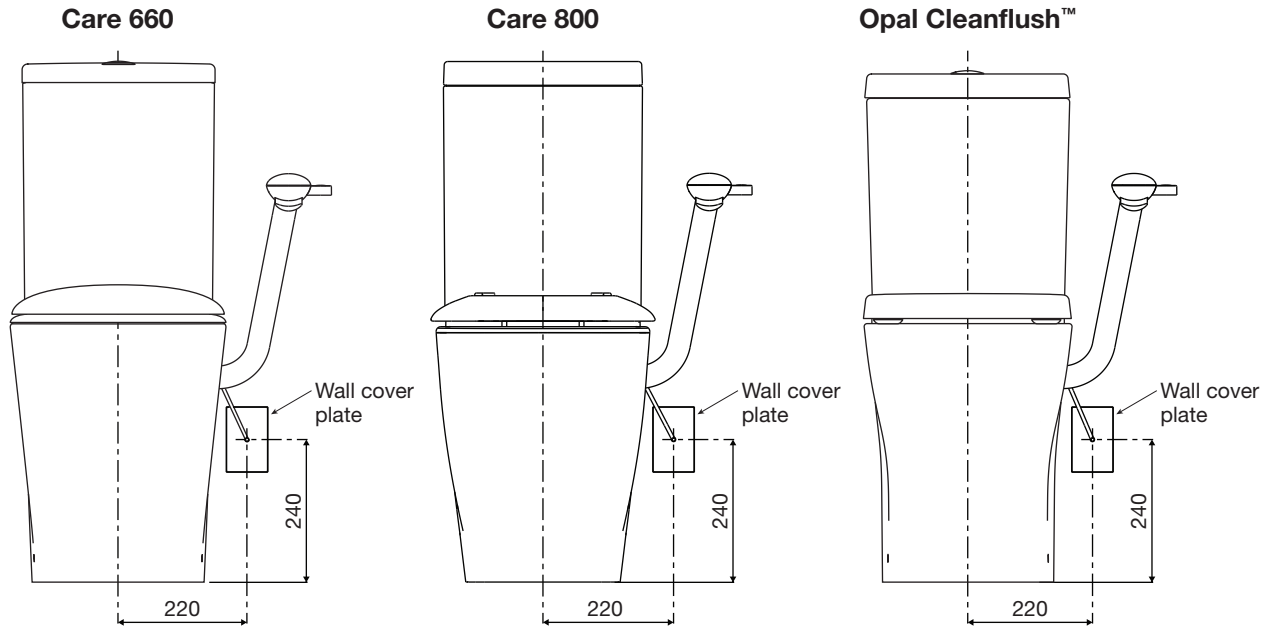

**Fig. 1**

1. Nurse call button wiring cable must be connected through wall cover plate (not supplied) and hard wired into the nurse call system as shown in **Fig. 1**. Schematic diagram is shown below in **Fig. 2**. Cable must not interfere with arm rotation.

### Nurse Call Button Service

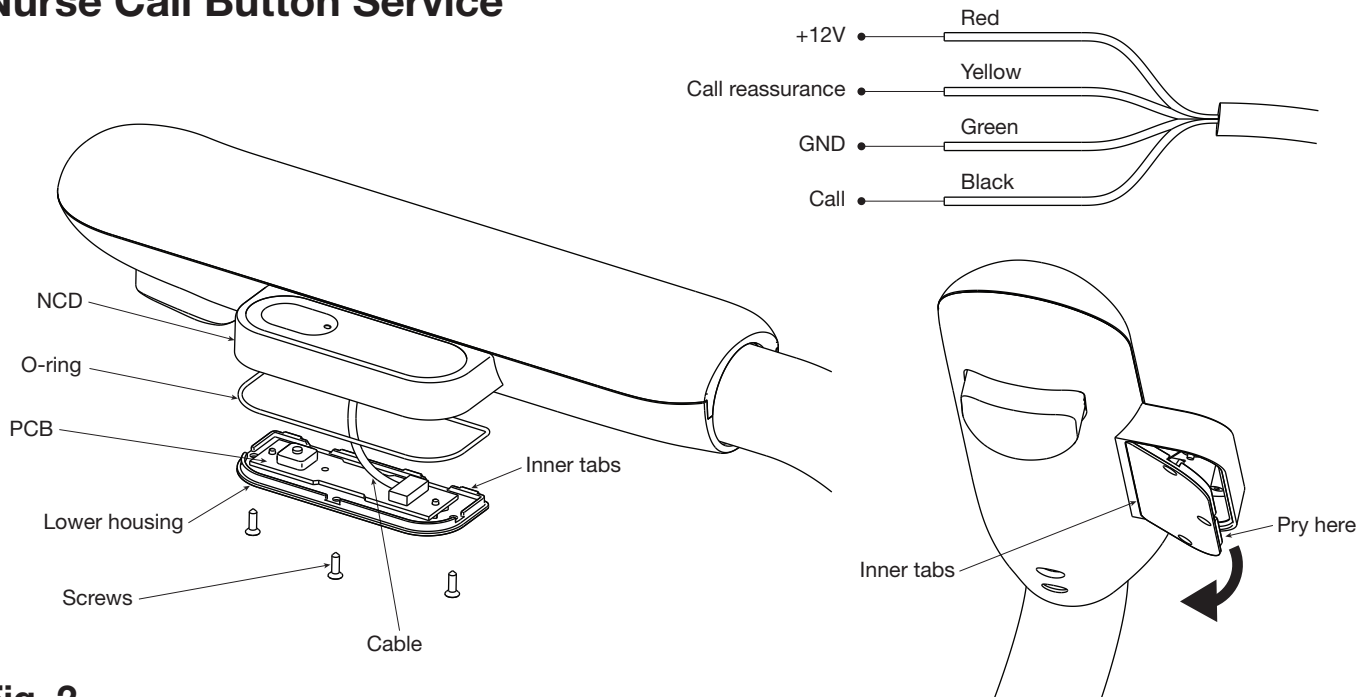

**Fig. 2**

2. PCB, cable and button can be accessed by removing the three screws on the lower housing. Using a thin flat blade screwdriver the lower housing can be pried away from the upper housing in the direction shown in **Fig. 2**. When reassembling engage inner tabs first and ensure O-ring is in place.